

Permit Application



Customer Number
if known

--	--	--	--	--	--

MDIA Office

Number _____

Location of Proposed Work or Improvement

Municipality* _____ County* _____

Site Address* _____ Tax Parcel # _____

City _____ State _____ Zip code _____

Lot # _____ Subdivision/Land Development _____ Phase _____ Section _____

Owner* _____ Phone #* _____ Fax # _____

Mailing Address* _____ E-Mail _____

City _____ State _____ Zip code _____

Principal Contractor* _____ Phone #* _____ Fax # _____

Mailing Address* _____ E-Mail _____

City _____ State _____ Zip code _____

Architect _____ Phone # _____ Fax # _____

Mailing Address _____ E-Mail _____

City _____ State _____ Zip code _____

Type of Work or Improvement* (Select all that apply)

- New Building Addition Alteration Repair Demolition Relocation Energy
- Foundation Only Change of Use Plumbing Mechanical Electrical Fire Protection

Describe the proposed work

Estimated Cost of Construction* (reasonable fair market value)

a. Structural Cost	\$	
Installation(s) not included in above cost		
b. Electrical	\$	
c. Plumbing	\$	
d. Heating, Air Conditioning	\$	
e. Other _____	\$	
Total Cost of Project (a+b+c+d+e)	\$	

Description of Building Use *(Select One)

Residential

- One-Family Dwelling (R-3)
- Two-Family Dwelling (R-2)
- Multi-Family (R-2)
- Hotels (R-1)

Non-Residential

Specific Use: _____
 Use Group: _____
 Change in Use: Yes No
 If YES, Indicate Former: _____
 Maximum Occupancy Load: _____
 Maximum Live Load: _____

Building/Site Characteristics

Number of Residential Dwelling Units: _____ Existing _____ Proposed

Mechanical: Indicate Type of Heating/Ventilating/Air Conditioning (i.e., electric, gas, oil, etc.) _____

Water Service: (Select) Yes No

Sewer Service: (Select) Yes No Septic Permit # _____

Does or will your building contain any of the following:

Fireplace(s): Number _____ Type of Fuel _____ BTU's _____ Type Vent _____

Elevator/Escalators/Lifts/Moving walks: (Select) Yes No

Sprinkler System: Yes No

Pressure Vessels: Yes No

Refrigeration Systems: Yes No

BUILDING DIMENSIONS

Existing Building Area: _____ sq.ft. Number of Stories: _____

Proposed Building Area: _____ sq.ft. Height of Structure Above Grade: _____ ft.

Total Building Area: _____ sq.ft. Area of Largest Floor: _____ sq.ft.

FLOODPLAIN

Is the site located within an identified flood prone area? (Select One) Yes No

Will any portion of the flood prone area be developed? (Select One) Yes No N/A

Owner/Agent shall verify that any proposed construction activity complies with the requirements of the National Flood Insurance Program and the Pennsylvania Flood Plain Management Act (Act 166-1978), specifically Section 60.3 (d).

HISTORIC DISTRICT

Is the site located within a Historic District? Yes No

If any construction is within a Historic District, a certificate of appropriateness may be required by the Municipality.

The applicant certifies that all information on this application is correct and the work will be completed in accordance with the "approved" construction documents and PA Act 45 (Uniform Construction Code) and any additional approved building code requirements adopted by the Municipality. The property owner and applicant assumes the responsibility of locating all property lines, setback lines, easements, rights-of way, flood areas, etc. Issuance of a permit and approval of construction documents shall not be construed as authority to violate, cancel or set aside any provisions of the codes or ordinances of the Municipality or any other governing body. The applicant certifies he/she understands all the applicable codes, ordinances and regulations.

Application for a permit shall be made by the owner or lessee of the building or structure, or *agent* of either, or by the *registered design professional* employed in connection with the proposed work.

I certify that the code administrator or the code administrator's authorized representative shall have the authority to enter areas covered by such permit at any reasonable hour to enforce the provisions of the code(s) applicable to such permit.

Signature of Owner or Authorized Agent

Print Name of Owner or Authorized Agent

Address _____
Date

Directions to Site:

* Indicates required field.

READ, UNDERSTAND AND COMPLY WITH THE FOLLOWING NOTICES

NOTICE: In addition to a zoning/construction permit, if the subject property does or will require access to a public road or street, and/or will require improvement/change of existing driveway access to a public road or street. If such public road or street is under the jurisdiction of the Commonwealth of Pennsylvania, you must obtain a Highway Occupancy Permit pursuant to Act no. 428 of 1945, as amended, known as the "State Highway Law", Application for such Highway Occupancy Permit as to a Commonwealth road or street must be made to, with and processed by the Pennsylvania Department of Transportation. If such road or street is under the jurisdiction of North Sewickley Township, you must apply for and obtain a Driveway Permit from the Township.

NOTICE: In addition to a zoning/construction permit, you may need to make other applications and obtain other permits for the development you propose, including but not limited to, depending on location of your premises, for an on-lot sewage permit and/or connection to a public sewer connection permit, water connection permit, and/or Land Development approval, prior to being able to commence construction. Further, following construction and prior to placing into use the proposed structure/building, you will need to procure an Occupancy Permit.

NOTICE: Contractor prohibited by law from employing any individual to perform work pursuant to this building permit unless contractor provides proof of worker's compensation to North Sewickley Township. Contractor also prohibited by law as to building or remodeling under subject Permit from engaging the services of a subcontractor unless subcontractor maintains workers' compensation insurance coverage as to subcontractor's employees. Failure of Contractor and Applicant for this Permit to maintain worker's compensation insurance according to law of Commonwealth of Pennsylvania, and as to said insurance, naming North Sewickley Township as a named insured, coverage requires stoppage of all construction/work under Zoning/Construction Permit issued and a Zoning/Construction Permit may be revoked.

NOTICE: Property owner is responsible for determining if property is subject to private covenants or private plan restrictions and compliance with the restrictions. Private covenants may be more restrictive than zoning/township regulations. Issuance of a building or zoning/construction permit does not constitute compliance with private covenants or restrictions. Permits issued in violation of any private covenants or restrictions are the sole responsibility of the property owner or their authorized representatives.

STATEMENTS AND VERIFICATION BY APPLICANT

I do hereby agree to observe and adhere to any and all provisions of the North Sewickley Township Zoning/UCC Code, and do further agree and understand that my failure to do so shall constitute a violation as to any Permit issued per this Application, which violation shall cause any Permit to become Null and Void, and revocable by North Sewickley Township via its Zoning Officer or other designated agent.

I/We hereby certify that as applicants, owners, contractors, agents or others that I/we completed and read the foregoing Application and that the information and statements in this application and other representations contained in all accompanying plans are made a part of this application and are true and correct to the best of my/our knowledge and belief. This statement and verification are made subject to the penalties of 18 P.A.C.S.A. Section 4904 relating to unsworn falsifications to authorities, which provides that if I/We knowingly make false statements of averments, I/We may be subject to criminal penalties. I/We hereby authorize representatives of the township to make required inspections upon the property to verify that the construction requested under this application complies with the North Sewickley Township Zoning Ordinance and other applicable codes.

If applicant is Contractor or Agent of Owner, he/she hereby certifies that he/she has the authority to act on behalf of the Owner.

OWNER(S) _____ DATE _____
CONTRACTOR OR AGENT _____ DATE _____

RECEIVED OF _____, THE SUM OF \$ _____, FEE FOR THE ABOVE
NUMBERED BUILDING/ZONING PERMIT APPLICATION. DATED: _____, 20____.

AUTHORIZED SIGNATURE

ZONING/CONSTRUCTION PERMIT (ISSUED) (DENIED) ON THE _____ DAY OF _____, 20____

[NOTE IF DENIED, LETTER SETTING FORTH REASONS WILL ACCOMPANY DENIAL NOTICE.]

ZONING OFFICER

UNIFORM CONSTRUCTION CODE PERMIT (ISSUED) (DENIED) ON THE _____ DAY OF _____, 20____

BUILDING CODE OFFICIAL

WORKERS' COMPENSATION INSURANCE COVERAGE INFORMATION

Please check one of the options below pertaining to your application:

Option A.

_____ Property owner is hiring a Contractor, stating that "Contractor" is within the meaning of the Pennsylvania Workers' Compensation Law - **WORKERS' COMPENSATION INSURANCE MUST BE ATTACHED AND PROVIDED TO THE MUNICIPALITY.**

Option B.

AFFIDAVIT OF EXEMPTION

If one of the reasons below is the owner's situation, this paper **NEEDS TO BE NOTARIZED**. The undersigned affirm that he/she is not required to provide workers' compensation insurance under the provisions of Pennsylvania's Workers' Compensation Law for one of the following reasons, as indicated: (please check one)

- _____ Property owner performing own work. If property owner does hire contractor to perform any work pursuant to building permit, contractor must provide proof of workers' compensation insurance to the municipality. Homeowner assumes liability for contractor compliance with this requirement.
- _____ Contractor has no employees. Contractor prohibited by law from employing any individual to perform work pursuant to this building permit unless contractor provides proof on insurance to the municipality.
- _____ Religious exemption under the Workers' Compensation Law. All employees of contractor are exempt from workers' compensation insurance (**COPIES OF RELIGIOUS EXEMPTION LETTERS FOR ALL EMPLOYEES MUST BE ATTACHED AND PROVIDED TO THE MUNICIPALITY**).

 Signature of Applicant

Address _____

County of _____

Municipality of _____

Subscribed, sworn to and acknowledged before me on this _____ day of _____, 20 ____.

Signature of Notary Public

My Commission expires: _____

(SEAL)

APPLICATION FOR ZONING OCCUPANCY PERMIT

**NORTH SEWICKLEY TOWNSHIP
893 MERCER ROAD
BEAVER FALLS, PA 15010**

Certificate No. _____

Telephone No. _____

OWNER: _____

ADDRESS: _____

LOT NO. _____ IN THE _____ PLAN OF LOTS

TAX PARCEL NO. _____

PROPOSED USE: _____

BUSINESS NAME: _____

APPROXIMATE DATE OF COMPLETION: _____

DO YOU NOW OR WILL YOU EVER GENERATE; STORE; TRANSPORT; OR DISPOSE OF ANY HAZARDOUS MATERIALS OR WASTE AS DEFINED BY THE U.S. ENVIRONMENTAL PROTECTION AT THIS LOCATION:

YES _____ NO _____

IF YES, PLEASE INDICATE MATERIAL(S) AND QUANTITY ON REVERSE.

I HEREBY ACKNOWLEDGE THAT THE ABOVE INFORMATION IS TRUE AND CORRECT AND THAT ALL APPLICABLE PROVISIONS OF THE NORTH SEWICKLEY TOWNSHIP ORDINANCES HAVE BEEN COMPLIED WITH:

DATE FILED _____

SIGNATURE OF OWNER/AGENT

DATE ISSUED _____

ZONING AND CODES OFFICER

BUILDING PERMIT RELEASE FORM

North Sewickley Township Sewer Authority
893 Mercer Road
Beaver Falls, PA 15010

Property Owner: _____

Address: _____

Parcel Number: _____

Township: _____

Property Owner Signature

Date

BELOW IS TO BE COMPLETED BY NORTH SEWICKLEY TOWNSHIP SEWER AUTHORITY

_____ The above named person has paid the required tap-in fee and may acquire a building permit from North Sewickley Township.

_____ The above named person is not required to pay the tap-in fee and may acquire a building permit from North Sewickley Township.

_____ The above property is within the boundaries of the public sewer area and the owner is not intending to use water or public sewers; however, if illegal use of water & sewers is found, the owner will be subject to penalties relating to illegal tap-in and usage as described in the North Sewickley Township Sewer Authority's Rules & Regulations – Section 1 – 15.

North Sewickley Township Sewer Authority Signature

Date

Example

NAME OF ADJACENT PROPERTY OWNER

NAME OF ADJACENT PROPERTY OWNER

NAME OF ADJACENT PROPERTY OWNER

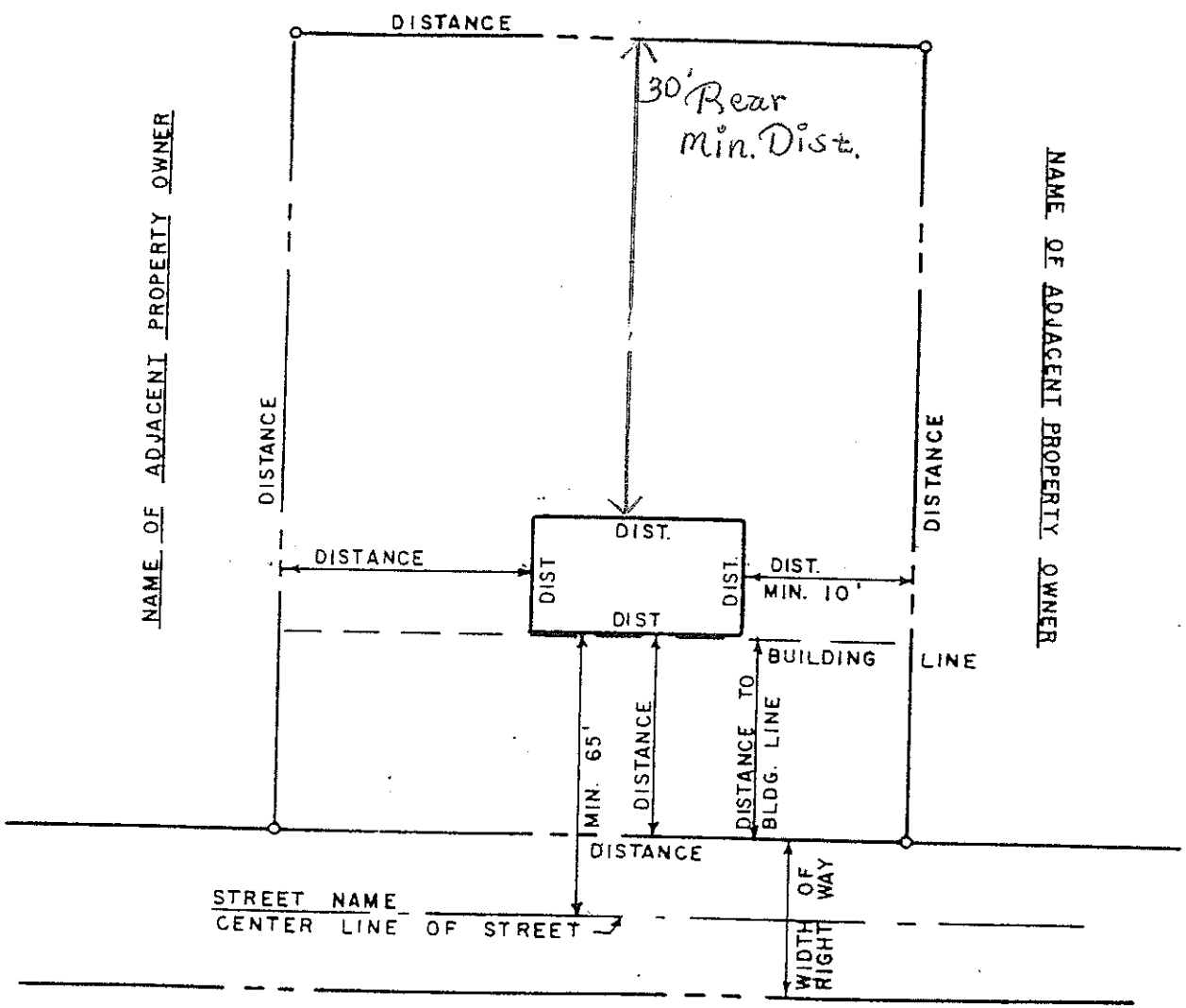

WATER SUPPLY
 WELL CITY

SEWAGE DISPOSAL
 SEPTIC PUBLIC

NAME OF APPLICANT... _____

DATE... _____

TYPICAL SKETCH for BUILDING PERMIT

**CUSTOMER ASSISTANCE GUIDE
BUILDING PERMIT APPLICATION SUBMITTAL REQUIREMENTS**

**SWIMMING POOLS (IN-GROUND OR ABOVE-GROUND),
SPAS AND HOT TUBS (CONTAINS WATER OVER 24 INCHES DEEP)**

- Please read all of the following information.
- The following is a check list. You must have a "checkmark" in all the sections listed below prior to submitting your application.

_____ "Affidavit of Exemption" (See attached form) If you are hiring a contractor to construct your pool, and they have workers' compensation, have the contractor or their insurance carrier provide us with a "Certificate of Insurance" showing proof of such. If the homeowner or a contractor without workers' compensation is constructing the pool, the attached form must be completed and notarized.

_____ A site plan showing the proposed pool, hot tub or spa location including the distances in feet, to the front, sides and rear property lines.

_____ Three (3) sets of complete construction documents that show in detail code compliance for all of the work proposed to include but not limited to the following information;

_____ Safety barrier – show type for your specific pool installation, (fence, walls, etc.) including height. (Barrier requirements attached).

_____ If installing deck at pool – take submittal requirements for deck also.

_____ Electrical service (pump, filter, receptacles, etc.) show location and type of wiring method. (Electrical requirements attached).

_____ Completed building permit application.

MDIA will review plans submitted to determine code compliance. If the minimum submittal requirements are not met, we will ask the applicant to supply additional information. If the minimum requirements are met, the plans will be marked "approved". A building permit will be issued and the applicant will be notified of the inspection fees and when they can pick-up the permit at the Municipal Building. All fees shall be paid prior to the issuance of the permit. Then use the inspection procedures provided to have all of the required inspections performed.

Safe digging is
no accident!

Know what's
below.

Dial 8-1-1
before you dig.

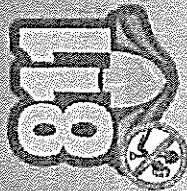

TEMPORARY MARKING GUIDELINES

	Proposed Excavation
	Temporary Survey Markings
	Electric Power Lines, Cables, Conduit and Lighting Cables
	Gas, Oil, Steam, Petroleum or Gaseous Materials, Fire, Steam, or Hot Liquids
	Communication Lines, Cable, or Conduit and Traffic Loops
	Fresh Water
	Reclaimed Water, Infiltration and Storm Lines
	Sewers and Other Lines

The following information is needed when you call PA One Call System.

- YOUR TELEPHONE NUMBER**
- YOUR MAILING ADDRESS**
- COUNTY** - The name of the county where the work will take place
- MUNICIPALITY** - City, Township or Borough where the work will take place
- THE ADDRESS WHERE THE WORK WILL TAKE PLACE**
- THE NEAREST INTERSECTING STREET TO THE WORK SITE**
- THE NAME OF A SECOND INTERSECTION NEAR THE WORK SITE**
- MARKER IN WHITE** - Yes or No
- OTHER INFORMATION THAT WOULD HELP THE LOCATOR FIND THE SITE** - Clarifying information to specify the exact location of the dig
- THE TYPE OF WORK BEING DONE**
- WHETHER THE WORK WILL TAKE PLACE IN: Street, Sidewalk, Public or Private Property**
- THE APPROXIMATE DEPTH YOU ARE DIGGING**
- THE EXTENT OF THE EXCAVATION** - The approximate size of the opening and the depth
- THE METHOD OF EXCAVATION** - How will the earth be removed?
- WHO IS THE WORK BEING DONE FOR**
- PERSON TO CONTACT IF THE UTILITIES HAVE QUESTIONS**
- THE CONTACT PERSON'S PHONE NUMBER** - The phone number with area code for daytime contact
- THE BEST TIME TO CALL**
- FAX NUMBER AND/OR EMAIL ADDRESS** - The responses from the utilities will be sent to you
- SCHEDULED START AND STOP DATE AND START TIME** - Scheduled start and stop date and start time - business days
- DURATION OF A JOB** - How long will the job take
- ANY ADDITIONAL REMARKS YOU MAY HAVE**

You will be given a 10 digit aerial number as confirmation of your call and our system will send you the responses from the utilities on the morning of your scheduled excavation date via fax or email

Know what's below,
Dial 8-1-1 before you dig.

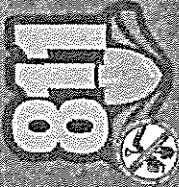

www.pa811.org

What do we do?

We are the "Call before you dig" company for all of Pennsylvania. If you plan to disturb the earth with powered equipment, you are required by Pennsylvania law to notify the underground utility companies of your intent to do so. Notification occurs by calling 8-1-1 or 1-800-242-1776, 24 hours of the day, every day of the year. Notification can also be done on our website at www.paonecall.org.

We will then notify the utility companies nearby of your intent to dig. The utility companies are responsible to mark where their underground lines are located with colored flags, paint or chalk.

Please Note:

- PA One Call does not mark utility lines.
- In some cases, the utility company may not mark the service lines you own.
- If you need your sewer drain cleared, be sure to check www.paonecall.org/crossbars for call before you clear information or call 811 for more information.

Why should you call?

Safe digging is no accident! If you are installing a fence or deck or digging for a mailbox post, patio or other excavation project, it is important to know what's below. Dial 8-1-1 or 1-800-242-1776 before you dig. The utility companies do not want an accident, either. The best way to learn where underground utility lines are located is to call before you dig.

For more information, visit www.pa811.org



Homeowner Quick Tips

- One easy phone call to 8-1-1 three to ten business days before digging begins helps keep your neighborhood safe.
- Call on Monday or Tuesday if you plan to dig on Saturday or Sunday.
- The utility companies will mark where their underground lines are located with colored paint, flags or chalk.
- Do not remove the flags if you see them in your yard.
- Our service is no cost to homeowners.
- Did you hire someone to install your fence, deck or lawn patio? Ask to see the PA One Call serial number before allowing them to dig on your property.

The Excavator's Responsibility

- Dial 8-1-1 or 1-800-242-1776.
- Do not allow anyone to excavate on your property without calling.
- Always look for the markings on the ground before your dig date.
- If you do not see markings, do not allow anyone to dig. Wait for the lines to be marked by the utility.
- Whoever places the call will receive an email or fax with a list of facility owners who have marked or have not marked. Pay attention to this message.
- Respect the markings by not removing flags or disturbing the actual markings.
- Exercise care around the marked lines by hand digging.
- When the project is complete, the excavator should remove the flags or marks from the ground or pavement.
- Report mistakes by dialing 8-1-1. Report emergencies by dialing 911.

2. Swimming pools with a powered *safety cover* that complies with ASTM F 1346.

305.2 Outdoor swimming pools and spas. Outdoor pools and spas and indoor swimming pools shall be surrounded by a barrier that complies with Sections 305.2.1 through 305.7.

305.2.1 Barrier height and clearances. Barrier heights and clearances shall be in accordance with all of the following:

1. The top of the barrier shall be not less than 48 inches (1219 mm) above grade where measured on the side of the barrier that faces away from the pool or spa. Such height shall exist around the entire perimeter of the barrier and for a distance of 3 feet (914 mm) measured horizontally from the outside of the required barrier.
2. The vertical clearance between grade and the bottom of the barrier shall not exceed 2 inches (51 mm) for grade surfaces that are not solid, such as grass or gravel, where measured on the side of the barrier that faces away from the pool or spa.
3. The vertical clearance between a surface below the barrier to a solid surface, such as concrete, and the bottom of the required barrier shall not exceed 4 inches (102 mm) where measured on the side of the required barrier that faces away from the pool or spa.
4. Where the top of the pool or spa structure is above grade, the barrier shall be installed on grade or shall be mounted on top of the pool or spa structure. Where the barrier is mounted on the top of the pool or spa, the vertical clearance between the top of the pool or spa and the bottom of the barrier shall not exceed 4 inches (102 mm).

305.2.2 Openings. Openings in the barrier shall not allow passage of a 4-inch-diameter (102 mm) sphere.

305.2.3 Solid barrier surfaces. Solid barriers that do not have openings shall not contain indentations or protrusions that form handholds and footholds, except for normal construction tolerances and tooled masonry joints.

305.2.4 Mesh fence as a barrier. Mesh fences, other than chain link fences in accordance with Section 305.2.7, shall be installed in accordance with the manufacturer's instructions and shall comply with the following:

1. The bottom of the mesh fence shall be not more than 1 inch (25 mm) above the deck or installed surface or grade.
2. The maximum vertical clearance from the bottom of the mesh fence and the solid surface shall not permit the fence to be lifted more than 4 inches (102 mm) from grade or decking.
3. The fence shall be designed and constructed so that it does not allow passage of a 4-inch (102 mm) sphere under any mesh panel. The maximum vertical clearance from the bottom of the mesh fence and the solid surface shall not be more than 4 inches (102 mm) from grade or decking.

SECTION 305 BARRIER REQUIREMENTS

305.1 General. The provisions of this section shall apply to the design of barriers for pools and spas. These design controls are intended to provide protection against the potential drowning and near drowning by restricting access to such pools or spas. These requirements provide an integrated level of protection against potential drowning through the use of physical barriers and warning devices.

Exceptions:

1. Spas and hot tubs with a lockable *safety cover* that complies with ASTM F 1346.

4. An attachment device shall attach each barrier section at a height not lower than 45 inches (1143 mm) above grade. Common attachment devices include, but are not limited to, devices that provide the security equal to or greater than that of a hook-and-eye-type latch incorporating a spring-actuated retaining lever such as a safety gate hook.
5. Where a hinged gate is used with a mesh fence, the gate shall comply with Section 305.3.
6. Patio deck sleeves such as vertical post receptacles that are placed inside the patio surface shall be of a nonconductive material.
7. Mesh fences shall not be installed on top of onground residential pools.

305.2.5 Closely spaced horizontal members. Where the barrier is composed of horizontal and vertical members and the distance between the tops of the horizontal members is less than 45 inches (1143 mm), the horizontal members shall be located on the pool or spa side of the fence. Spacing between vertical members shall not exceed $1\frac{3}{4}$ inches (44 mm) in width. Where there are decorative cutouts within vertical members, spacing within the cutouts shall not exceed $1\frac{3}{4}$ inches (44 mm) in width.

305.2.6 Widely spaced horizontal members. Where the barrier is composed of horizontal and vertical members and the distance between the tops of the horizontal members is 45 inches (1143 mm) or more, spacing between vertical members shall not exceed 4 inches (102 mm). Where there are decorative cutouts within vertical members, the interior width of the cutouts shall not exceed $1\frac{3}{4}$ inches (44 mm).

305.2.7 Chain link dimensions. The maximum opening formed by a chain link fence shall be not more than $1\frac{3}{4}$ inches (44 mm). Where the fence is provided with slats fastened at the top and bottom which reduce the openings, such openings shall be not more than $1\frac{3}{4}$ inches (44 mm).

305.2.8 Diagonal members. Where the barrier is composed of diagonal members, the maximum opening formed by the diagonal members shall be not more than $1\frac{3}{4}$ inches (44 mm). The angle of diagonal members shall be not greater than 45 degrees (0.79 rad) from vertical.

305.2.9 Clear zone. There shall be a clear zone of not less than 36 inches (914 mm) between the exterior of the barrier and any permanent structures or equipment such as pumps, filters and heaters that can be used to climb the barrier.

305.2.10 Poolside barrier setbacks. The pool or spa side of the required barrier shall be not less than 20 inches (508 mm) from the water's edge.

305.3 Gates. Access gates shall comply with the requirements of Sections 305.3.1 through 305.3.3 and shall be equipped to accommodate a locking device. Pedestrian access gates shall open outward away from the pool or spa, shall be self-closing and shall have a self-latching device.

305.3.1 Utility or service gates. Gates not intended for pedestrian use, such as utility or service gates, shall remain locked when not in use.

305.3.2 Double or multiple gates. Double gates or multiple gates shall have at least one leaf secured in place and the adjacent leaf shall be secured with a self-latching device. The gate and barrier shall not have openings larger than $\frac{1}{2}$ inch (12.7 mm) within 18 inches (457 mm) of the latch release mechanism. The self-latching device shall comply with the requirements of Section 305.3.3.

305.3.3 Latches. Where the release mechanism of the self-latching device is located less than 54 inches (1372 mm) from grade, the release mechanism shall be located on the pool or spa side of the gate not less than 3 inches (76 mm) below the top of the gate, and the gate and barrier shall not have openings greater than $\frac{1}{2}$ inch (12.7 mm) within 18 inches (457 mm) of the release mechanism.

305.4 Structure wall as a barrier. Where a wall of a dwelling or structure serves as part of the barrier and where doors or windows provide direct access to the pool or spa through that wall, one of the following shall be required:

1. Operable windows having a sill height of less than 48 inches (1219 mm) above the indoor finished floor and doors shall have an alarm that produces an audible warning when the window, door or their screens are opened. The alarm shall be *listed* and *labeled* as a water hazard entrance alarm in accordance with UL 2017. In dwellings or structures not required to be Accessible units, Type A units or Type B units, the operable parts of the alarm deactivation switches shall be located 54 inches (1372 mm) or more above the finished floor. In dwellings or structures required to be Accessible units, Type A units or Type B units, the operable parts of the alarm deactivation switches shall be located not greater than 54 inches (1372 mm) and not less than 48 inches (1219 mm) above the finished floor.
2. A *safety cover* that is *listed* and *labeled* in accordance with ASTM F 1346 is installed for the pools and spas.
3. An *approved* means of protection, such as self-closing doors with self-latching devices, is provided. Such means of protection shall provide a degree of protection that is not less than the protection afforded by Item 1 or 2.

305.5 Onground residential pool structure as a barrier. An onground residential pool wall structure or a barrier mounted on top of an onground residential pool wall structure shall serve as a barrier where all of the following conditions are present:

1. Where only the pool wall serves as the barrier, the bottom of the wall is on grade, the top of the wall is not less than 48 inches (1219 mm) above grade for the entire perimeter of the pool, the wall complies with the requirements of Section 305.2 and the pool manufacturer allows the wall to serve as a barrier.

GENERAL COMPLIANCE

2. Where a barrier is mounted on top of the pool wall, the top of the barrier is not less than 48 inches (1219 mm) above grade for the entire perimeter of the pool, and the wall and the barrier on top of the wall comply with the requirements of Section 305.2.
3. Ladders or steps used as means of access to the pool are capable of being secured, locked or removed to prevent access except where the ladder or steps are surrounded by a barrier that meets the requirements of Section 305.
4. Openings created by the securing, locking or removal of ladders and steps do not allow the passage of a 4-inch (102 mm) diameter sphere.
5. Barriers that are mounted on top of onground *residential* pool walls are installed in accordance with the pool manufacturer's instructions.

305.6 Natural barriers. In the case where the pool or spa area abuts the edge of a lake or other natural body of water, public access is not permitted or allowed along the shoreline, and required barriers extend to and beyond the water's edge not less than 18 inches (457 mm), a barrier is not required between the natural body of water shoreline and the pool or spa.

305.7 Natural topography. Natural topography that prevents direct access to the pool or spa area shall include but not be limited to mountains and natural rock formations. A natural barrier approved by the governing body shall be acceptable provided that the degree of protection is not less than the protection afforded by the requirements of Sections 305.2 through 305.5.

TYPICAL WIRING DIAGRAM FOR AN ABOVE-GROUND POOL SHOWING CODE REQUIRED METHODS AND EQUIPMENT

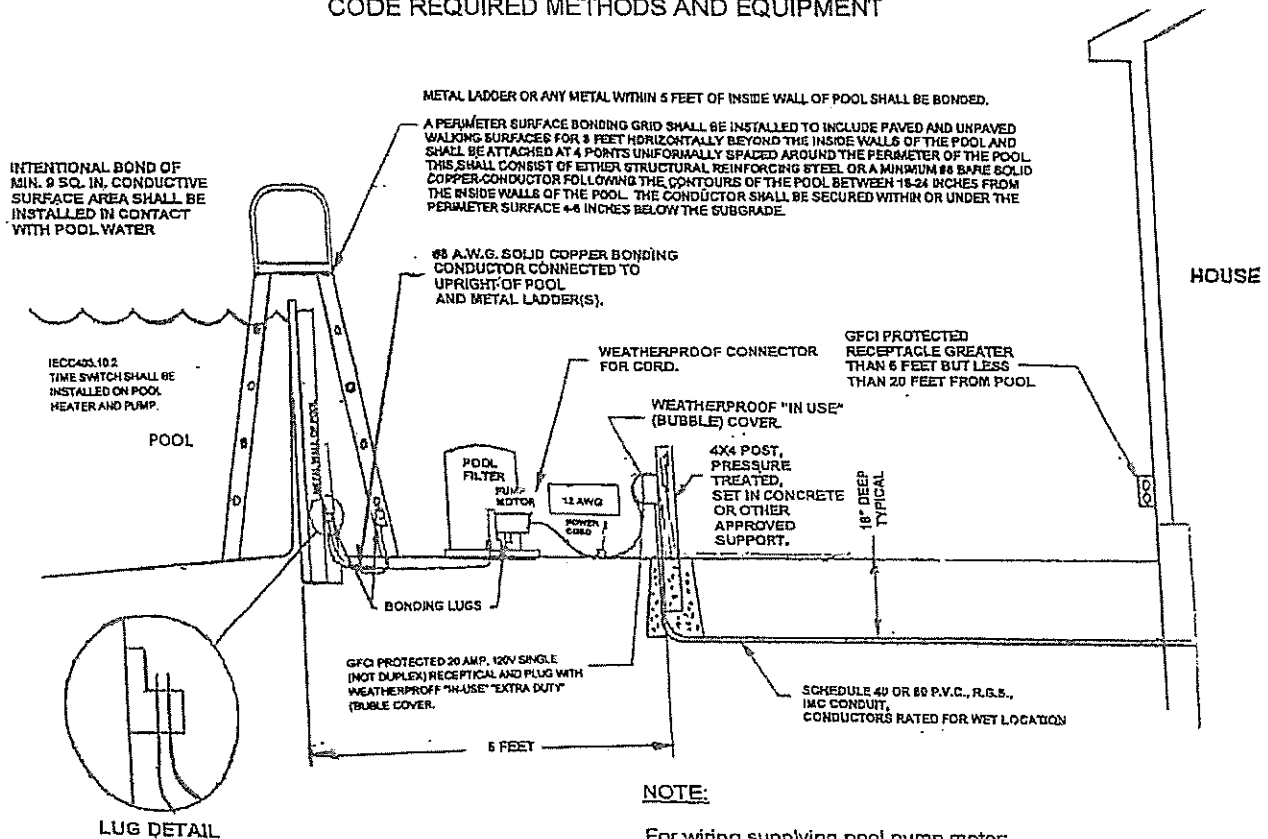

NOTE:

For wiring supplying pool pump motor:
Type NM and UF cable is permitted only for use within dwelling.